

## Serie | 8, Built-in Oven, 60 x 60 cm, HBG634BS1



### Included accessories

1 x enamel baking tray  
1 x combination grid  
1 x universal pan

## The built-in oven: you get perfect baking and roasting results.

- **4D Hot Air:** even heat distribution for perfect results – on any level.
- **TFT display control:** easy-to-use thanks to the control ring with full text and symbols.
- **EcoClean Direct:** almost no cleaning is necessary thanks to a special coating of the rear wall that automatically absorbs grime.
- **Drop Down door with SoftOpen and SoftClose:** the oven door opens and closes gently and quietly

### Technical data

Built-in / Free-standing :	Built-in
Integrated Cleaning system :	catalytic partial, Hydrolytic
Required niche size for installation (HxWxD) :	585-595 x 560-568 x 550
Dimensions :	595 x 594 x 548
Dimensions of the packed product (HxWxD) (mm) :	670 x 680 x 670
Control Panel Material :	Stainless steel
Door Material :	Glass
Net weight (kg) :	35.244
Usable volume of cavity (l) :	71
Cooking method :	Bottom heat, Conventional heat, Defrost, Full width grill, Half width grill, Hot Air-Eco, Hot air grilling, low temperature cooking, Pizza setting, pre-heating, warming
Number of interior lights :	1
Approval certificates :	CE, VDE
Length electrical supply cord (cm) :	120
Interior Lights - cavity 1 :	1
Pull-out system :	Accessory
Clock function :	Off, On, Start
Included accessories :	1 x enamel baking tray, 1 x combination grid, 1 x universal pan
Broil Element Wattages cavity 1 (W) :	2800
Convection Element Wattages cavity 1 (W) :	2200
Energy efficiency rating :	A+
Energy consumption per cycle conventional (2010/30/EC) :	0.87
Energy consumption per cycle forced air convection (2010/30/EC) :	0.69
Energy efficiency index (2010/30/EC) :	81.2
Connection Rating (W) :	3600
Current (A) :	16
Voltage (V) :	220-240
Frequency (Hz) :	50; 60
Plug type :	Gardy plug w/ earthing
Alternative colors available :	HBG634BB1, HBG634BW1
Energy input :	Electric
Approval certificates :	CE, VDE
Required cutout/niche size for installation (in) :	x x
Dimensions of the packed product (in) :	26.37 x 26.37 x 26.77
Net weight (lbs) :	78.000
Gross weight (lbs) :	83.000
Length electrical supply cord (cm) :	120
Net weight (kg) :	35.244
Gross weight (kg) :	37.6



4 242002 789019

## **Serie | 8, Built-in Oven, 60 x 60 cm, HBG634BS1**

**The built-in oven: you get perfect baking and roasting results.**

---

### **Type of oven / heating system:**

- Oven with 13 heating methods: 4D hot air, Hot Air-Eco, Conventional top and bottom heat, Conventional heat ECO, Hot air grilling, Variable full width grill, Half width grill, Pizza setting, Bottom heat, low temperature cooking, Defrost setting, Plate warming, Hold warm
- Cavity volume: 71 l
- Electronic clock
- Rapid heating-up
- Halogen interior lighting, Switch for oven illumination
- Total connected load electric: 3.6 KW

## Serie | 8, Built-in Oven, 60 x 60 cm, HBG634BS1

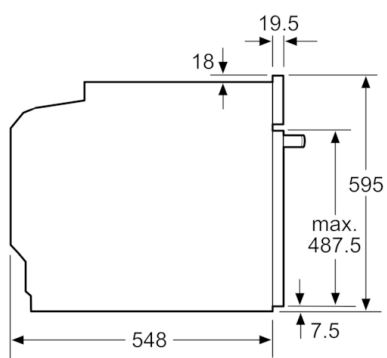

measurements in mm

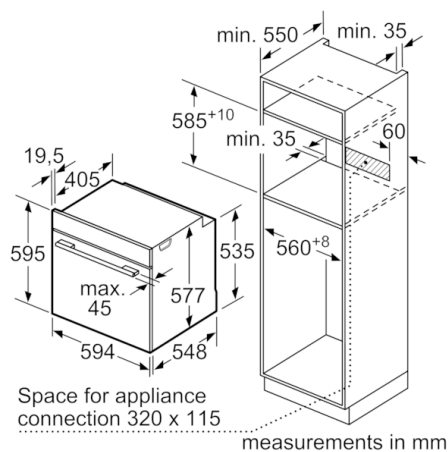

measurements in mm

If the appliance will be installed underneath a hob, the following worktop thicknesses (including substructure if necessary) must be taken into account.

Hob type	min. worktop thickness	
	fitted	flush
Induction hob	37 mm	38 mm
Full surface Induction hob	47 mm	48 mm
Gas hob	30 mm	38 mm
Electric hob	27 mm	30 mm

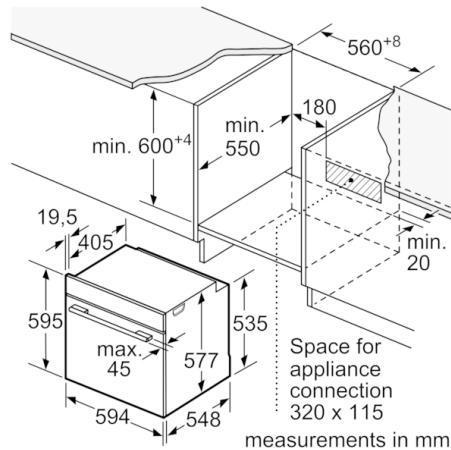

measurements in mm