

## iQ700, Built-in Compact Microwave Oven, 60 x 45 cm, CM656GBS1



### Optional accessories

HZ327000

- ✓ varioSpeed: reduce cooking times by up to 50%.
- ✓ fastPreheat: reach the required baking temperature sooner; coolStart: no need to preheat the oven for deep frozen food.
- ✓ Far less oven cleaning – ecoClean Plus.
- ✓ cookControl Plus: guaranteed success for numerous dishes.
- ✓ TFT Touchdisplay: user-friendly menu navigation with good display features.

### Features

#### Technical data

Type of micro-wave oven : MW-Combi  
 Type of control : Electronic  
 Dimensions : 455 x 594 x 548  
 Cavity dimensions (mm) : 237.0 x 480 x 392.0  
 Length electrical supply cord (cm) : 150  
 Net weight (kg) : 36.033  
 Gross weight (kg) : 38.3  
 Maximum micro-wave power (W) : 900  
 Number of Power Levels : 5  
 Turntable : No  
 Cavity material : Enamelled steel  
 Door opening : Handle  
 Clock : Yes  
 Height of the product (mm) : 455  
 Width of the appliance : 594  
 Depth of the product : 548  
 Maximum micro-wave power (W) : 900  
 Connection Rating (W) : 3600  
 Current (A) : 16  
 Voltage (V) : 220-240  
 Frequency (Hz) : 60; 50  
 Plug type : GARDY plug w/ earthing  
 Approval certificates : CE, VDE  
 Appliance Dimensions (h x w x d) (in) : x x  
 Dimensions of the packed product (in) : 21.25 x 25.59 x 26.77  
 Net weight (lbs) : 79.000  
 Gross weight (lbs) : 84.000



**iQ700, Built-in Compact Microwave  
Oven, 60 x 45 cm,  
CM656GBS1**

Features

**Type of oven / heating system:**

- Compact oven with microwave with 13 heating methods: 4D hot air, Hot Air-Eco, Conventional cooking, Conventional heat ECO, hot air grilling, Full width grill, Half width grill, Intensive hot air, Deep-frozen food special, Bottom heat, low temperature cooking, Plate warming setting, Hold warm setting
- Additional heating methods with microwave: microwave, combi microwave variable
- Max. Power: 900 W; 5 Microwave power settings (90 W,180 W,360 W,600 W,900 W) with Inverter (MW)
- Cavity volume: 45 l

**Cleaning:**

**Comfort:**

- LED clock and automatic programmer
- Rapid heating-up
- LED light, Independent oven interior light button
- Integral cooling fan
- Total connected load electric: 3.6 KW

iQ700, Built-in Compact Microwave  
Oven, 60 x 45 cm,  
CM656GBS1

Dimensioned drawings

Installation with a hob.

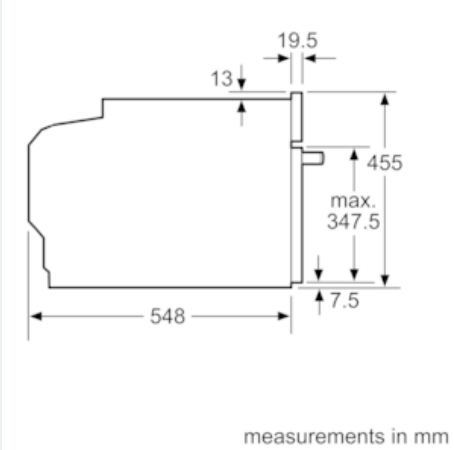
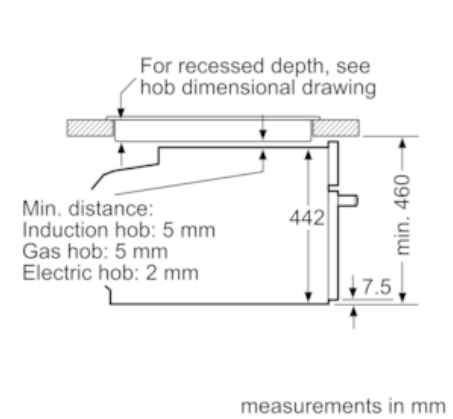

If the compact appliance will be installed underneath a hob, the following worktop thicknesses (including substructure if necessary) must be taken into account.

Hob type	min. worktop thickness	
	fitted	flush
Induction hob	42 mm	43 mm
Full surface Induction hob	52 mm	53 mm
Gas hob	32 mm	43 mm
Electric hob	32 mm	35 mm

